

REVISION RECORD				
REV	ECO	DESCRIPTION	DRFT	CHKD

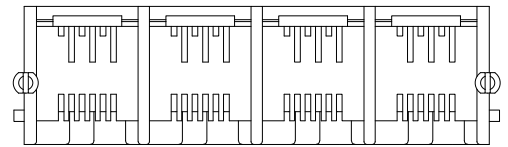
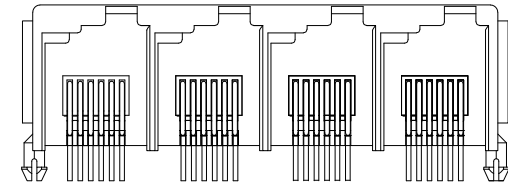
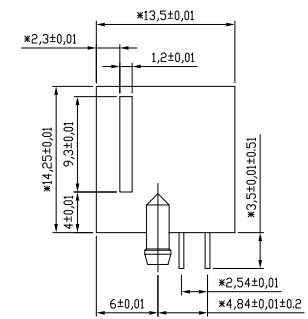
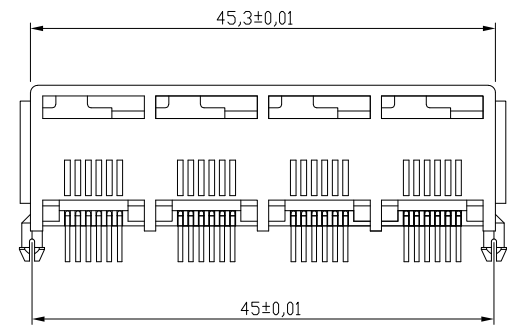

NOTES:

ELECTRICAL:

- VOLTAGE RATING : 125 VAC RMS.
- CURRENT RATING : 1.5 AMP.
- CONTACT RESISTANCE : 30 MILLIOHMS MAX.
- INSULATION RESISTANCE: 1000 MEGOHMS MIN @ 500 VDC.
- DIELECTRIC STRENGTH: 1000 VAC RMS 60Hz, 1MIN.

MECHANICAL:

- HOUSING MATERIAL : GLASS FILLED POLYESTER UL94V-0.
- CONTACT MATERIAL : PHOSPHOR BRONZE ϕ 0.46mm.
- PLATING : GOLD PLATING OVER NICKEL.
- OPERATING LIFE : 750 CYCLES MIN.
- PCB RETENTION PRE-SOLDER: 1 LB MIN.
- PCB RETENTION POST-SOLDER: 10 LBS MIN.

ENVIRONMENTAL:

- STORAGE : -40°C TO +85°C.
- OPERATION: 0°C TO 70°C.

MATES WITH MODULAR PLUG CONFORMING TO

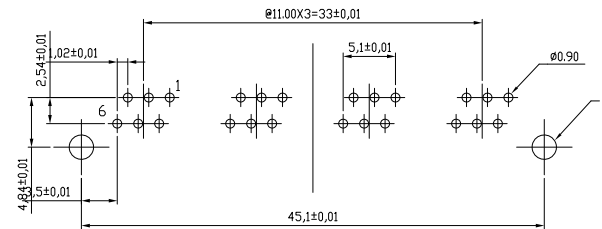

PC Board Layout Component Side Shown

DETACHED LISTS	MM (INCH)		DFTD DESIGNER DATE DATE		<h1 style="margin: 0;">Coorle Technology</h1>		
	TOLERANCES EXCEPT AS NOTED		CHKD SYNGE DATE 2004/2/17	MFD DATE			
	MM	±	APPVLCZH DATE 2004/2/17		TITLE MINI L/P SIDE ENTRY PCB JACK 8P		
	.0 ± 0.2	±	MATERIAL :				
.00 ± 0.15	±	ANGLES ± 0.5		QT'Y :	DRAWING NO. DRAWING_NO.	SIZE A3	REV 12/14/01
.000 ± 0.075	±	THIRD ANGLE PROJECTION		FINISH:	/PART NO. PART_NO.	0	
				SCALE :	DO NOT SCALE DRAWING	SHEET X OF Y	